

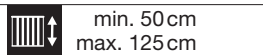

METRO-BOX FS4200

Drop arm awning with lateral guides

FS4200

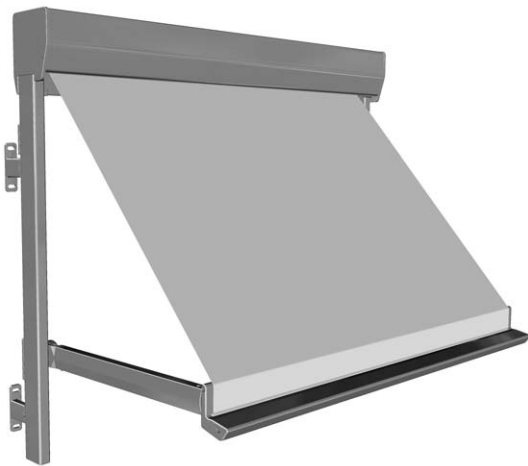
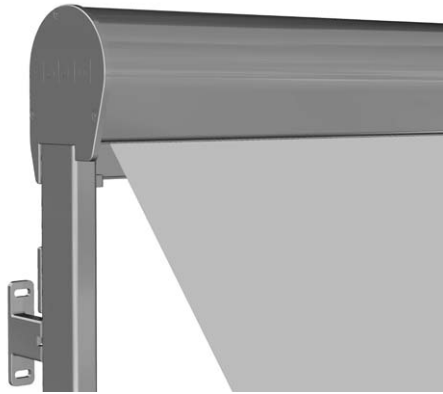

Description

One-piece protective box made of round or square aluminium extruded profile, 124 mm high and 107 mm wide. Standard drive occurs manually by means of permanently lubricated worm gearbox with speed reduction 4:1 and with end stop against reverse winding. Operation with aluminium tilted crank lever and operating handle made of aluminium. Grommet in the interior space with joint plate, projection angle 45°–90°. Connect tilted crank lever to drive with fixed, positive fitting, galvanized steel. The operating handle is made of corrosion-resistant square steel for coupled installations. Cassette end cap made of aluminium cast alloy with insertion spindle for guide rail support. Roller tube \varnothing 60 to \varnothing 78 mm (depending on dimension and hanging) made of sendzimir galvanized steel with groove for awning cover support. The L-shaped aluminium extruded declining profile with the dimensions 65 x 60 mm is equipped with an insertion groove for fitting and with a chamber for fixing arms. Flat steel is inserted in the weighting chamber for the declining profile for extra weight. Fibre-glass reinforced side end caps made of UV protected plastic. The box is completely closed with the retracted declining profile. Projection arms of extruded aluminium hollow profile with variable projection and integrated corrosion-resistant steel flat spiral springs for supporting a declining angle of up to 150°. Installed as unit on vertically arranged 50 x 23.5 mm guide rails of extruded aluminium c-section profile. The guide rail end caps are made of high-quality plastic. Soffit installation as direct screw coupling via bore holes in the guide rails or facade installation with suitable fixing brackets made of aluminium cast alloy. All aluminium profiles as well as aluminium cast parts are powder-coated. All screws are stainless steel. Fitted with awning cover made of polyester, PVC or acrylic from the STOBAG collection.

Options

Drive options:

- Worm drive (4:1) with end stop, with ring and hanging awning crank lever with hook
- Worm drive (4:1) with end stop, bayonet lock and hanging awning tilted crank lever with operating handle funnel

Electric drive:

With a mechanical limit switch: Tubular AC motor 230 V, 50Hz or 120 V, 60 Hz (according to the country) with electromechanical brakes and mechanically adjustable end stop. Thermal protection, protection class IP54 (spray water), with 50 – 150 cm connection cable.

With an electronic limit switch: Tubular AC motor 230 V, 50Hz or 120 V, 60 Hz (according to the country) with electromechanical brakes and electronic end stop. Thermal protection, protection class IP54 (spray water), with 50 – 150 cm connection cable.

Remote control motor with an electronic limit switch: Tubular AC motor 230 V, 50Hz or 120 V, 60 Hz (according to the country) with electromechanical brakes and electronic end stop. Integrated radio receiver, thermal protection, protection class IP54 (spray water), with 50 – 150 cm connection cable.

METHOD OF DELIVERY

Cover on roller tube and front rail and completely installed in the box.
Arms with guide rails loose



METRO-BOX FS4200

Drop arm awning with lateral guides

FS4200

Wall fixing (with round boxes)

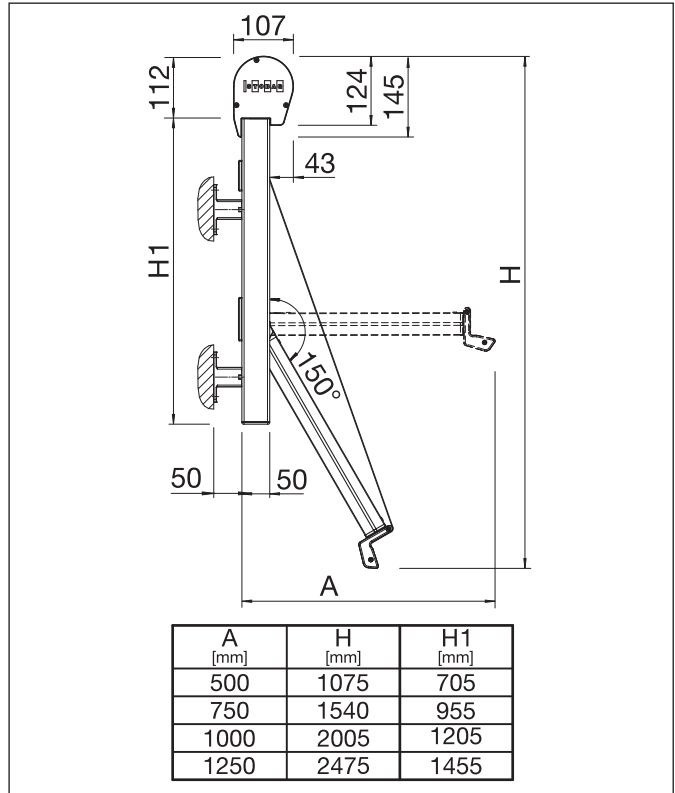
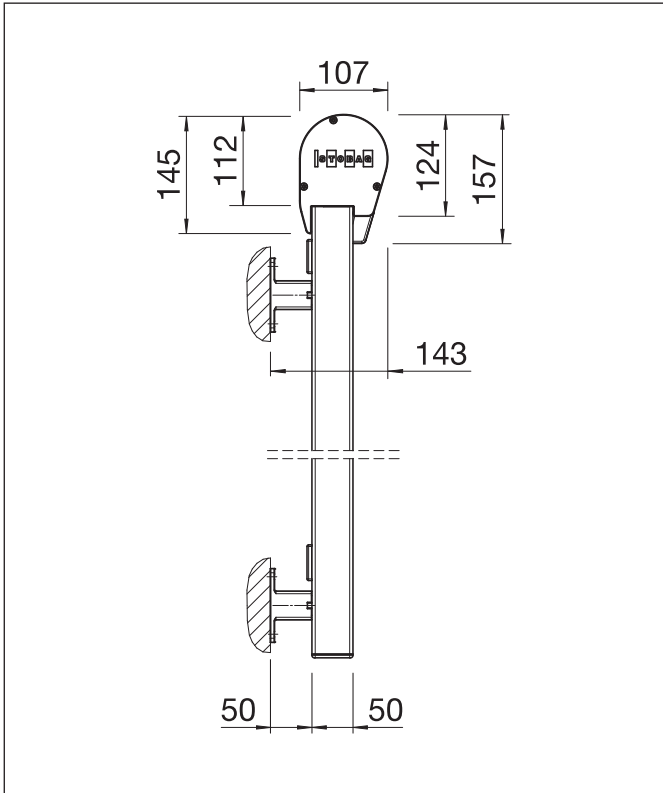

FS4200

Wall fixing (with square boxes)

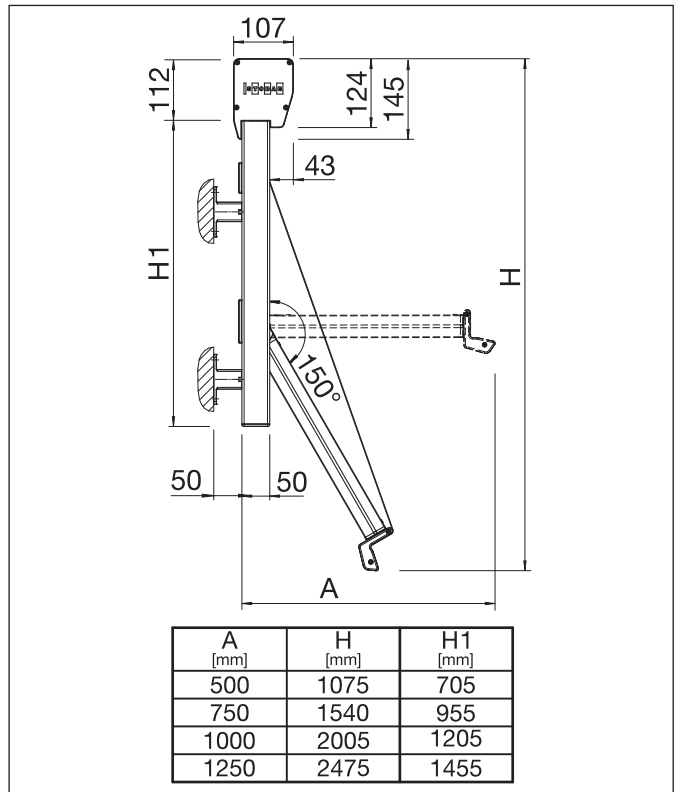
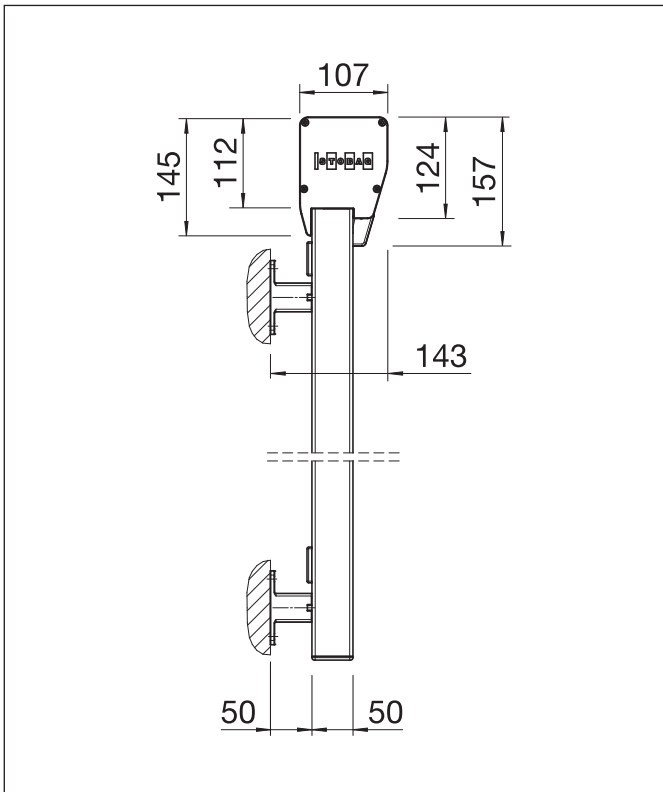



METRO-BOX FS4200

Drop arm awning with lateral guides

FS4200

Installation drawing (with round boxes)

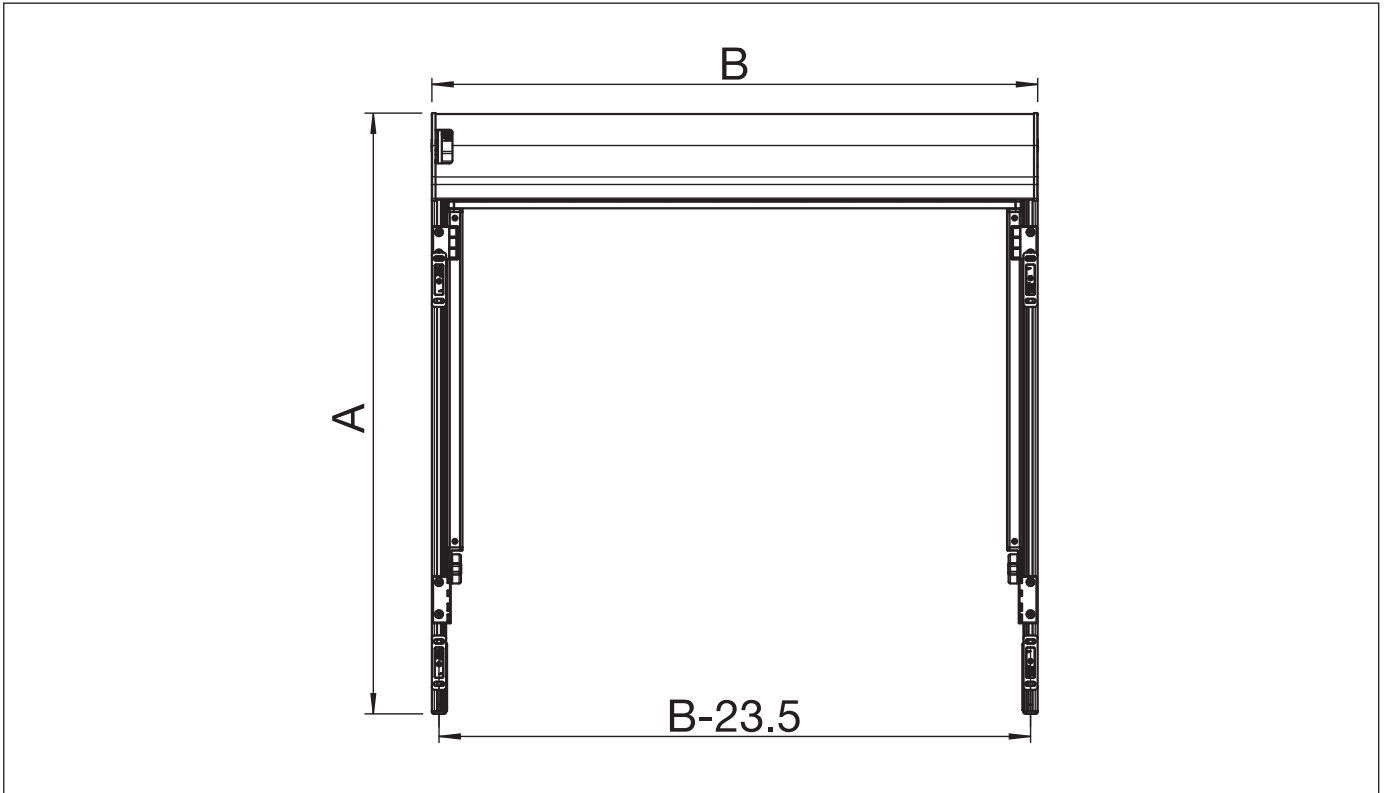

FS4200

Installation drawing (with square boxes)

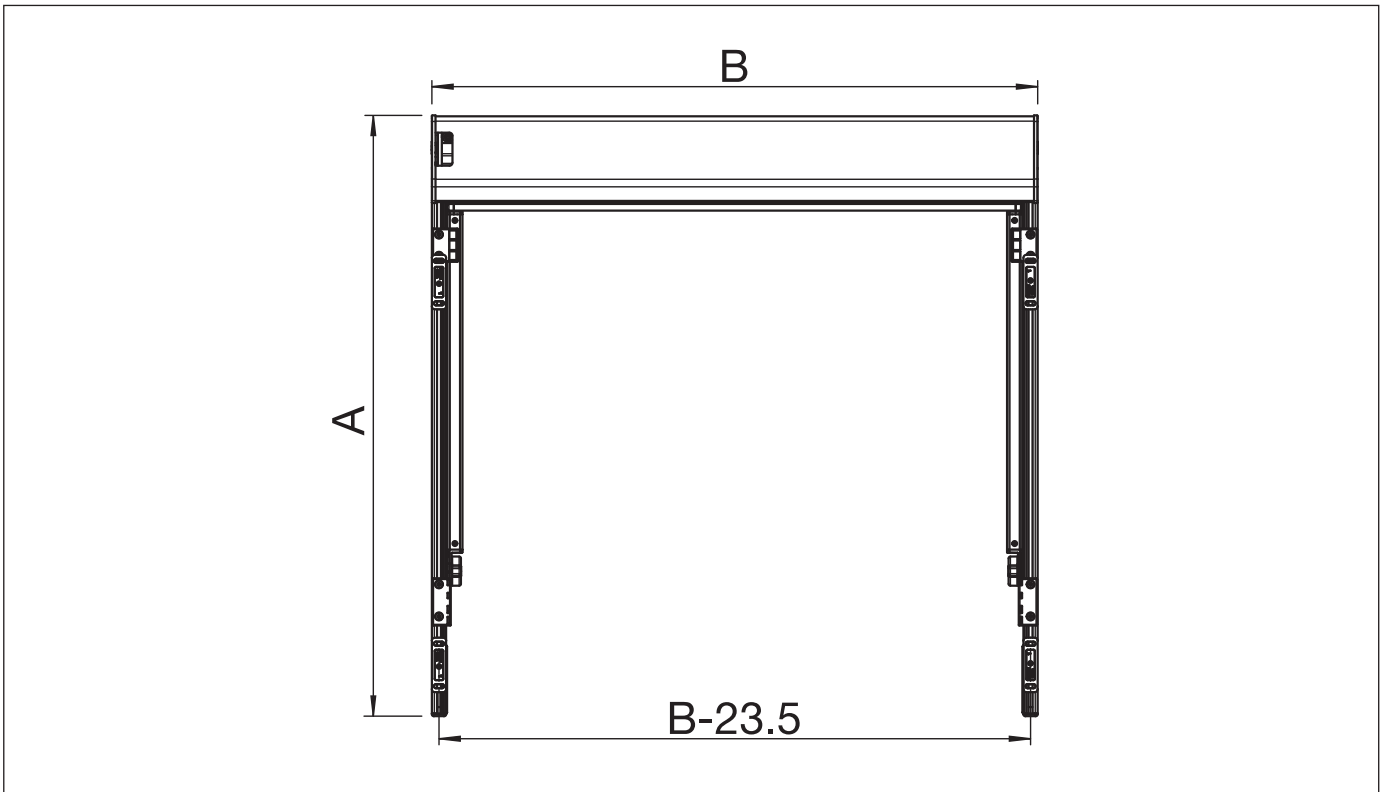

B = Total width
A = Total height