

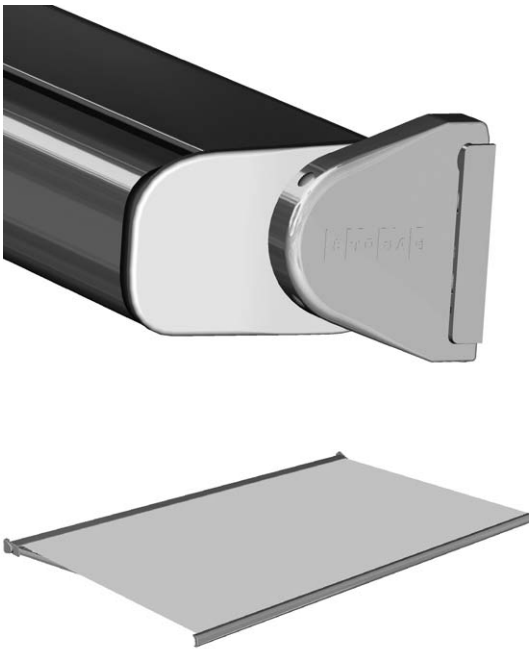



CASABOX BX2000

Cassette awning with folding arms

BX2000



| | | | |
|---|----------------------------|---|----------------------------|
|  | min. 188 cm max. 500 cm |  | min. 160 cm max. 300 cm |
|---|----------------------------|---|----------------------------|

| | |
|---|---|
|  | 0° – 76° Wall fixing 5° – 90° Top fixing 5° – 90° Rafter installation |
|---|---|

Minimal width for a given projection

| Projection | minimal width |
|--------------|---------------|
| 160cm | 188 |
| 180cm | 208 |
| 200cm | 228 |
| 225cm | 258 |
| 250cm | 288 |
| 300cm | 348 |

Description

One-piece U-shaped protective box (152 x 123 mm) of extruded aluminium profile as support element of structure with a groove at the upper end of profile for inserting sealing brush. Side cap as cassette end for accepting roller tube \varnothing 70 of galvanised steel and for securing folding arms. Securing flange (on side cap) with hooks for hanging the awning on the brackets used for wall or top installation. Fixing boom, side cap, bracket are all made of aluminium casting alloy. Awning is extended and retracted manually via a bevel gearbox with integrated end stop and freewheel operating handle ring, speed reduction 4.5:1. The bevel gearbox is operated via a removable operating handle of powder-coated metal in white, grey or brown with hook and plastic handle. Front profile of extruded aluminium in rounded (58 x 107 mm) or square (62 x 107 mm) shape with matching plastic end caps. Folding arms with inverse incline of aluminium extruded profiles and precision parts of aluminium cast alloy, internal tension springs and double stainless steel cables and cable protector over the middle joint. The angle of shade is infinitely adjustable via internal hexagon bolt in securing flange from 0° – 80° for wall installation, 5° – 90° for top installation.

All aluminium profiles are chromate coated. The aluminium profiles and aluminium cast parts are powder-coated in facade quality. All visible screws are stainless steel. The cover with a spin-dyed acrylic cloth (price category 1), colour fast, very high UV protection, good tensile strength, water and dirt resistant is from the STOBAG collection.

Option:

Brackets: In order to cater for different installation conditions such as poor brickwork, wood/steel structures, rafters etc., we offer a range of different types of brackets.

Wall installation profile: Aluminium extruded wall installation profile incl. side cap of aluminium sheet is attached to the facade to prevent rainwater dropping between the facade and the awning.

Electric drive:

With an electronic limit switch: Tubular AC motor 230 V, 50Hz or 120 V, 60 Hz (according to the country) with electromechanical brakes and electronic end stop. Thermal protection, protection class IP54 (spray water), with 50 – 150 cm connection cable.

Remote control motor with an electronic limit switch: Tubular AC motor 230 V, 50Hz or 120 V, 60 Hz (according to the country) with electromechanical brakes and electronic end stop. Integrated radio receiver, thermal protection, protection class IP54 (spray water), with 50 – 150 cm connection cable.

Cover / assembly technology: Awning covers of polyester, acrylic etc. and various assembly technologies such as gluing, TENARA stitching etc as per STOBAG collection (collection index).

METHOD OF DELIVERY

Awnings completely assembled, with cover



CASABOX BX2000

Cassette awning with folding arms

BX2000

Wall fixing

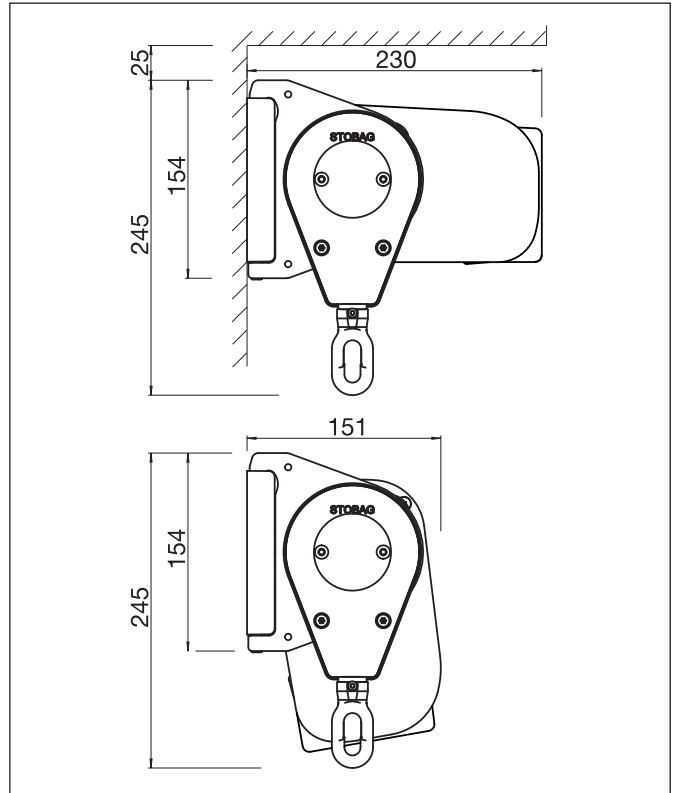
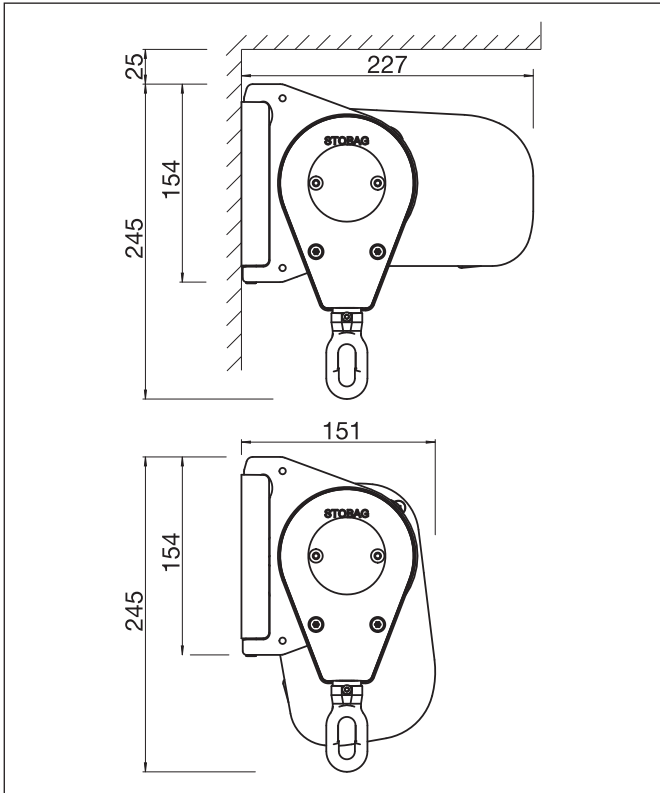

BX2000

Top fixing

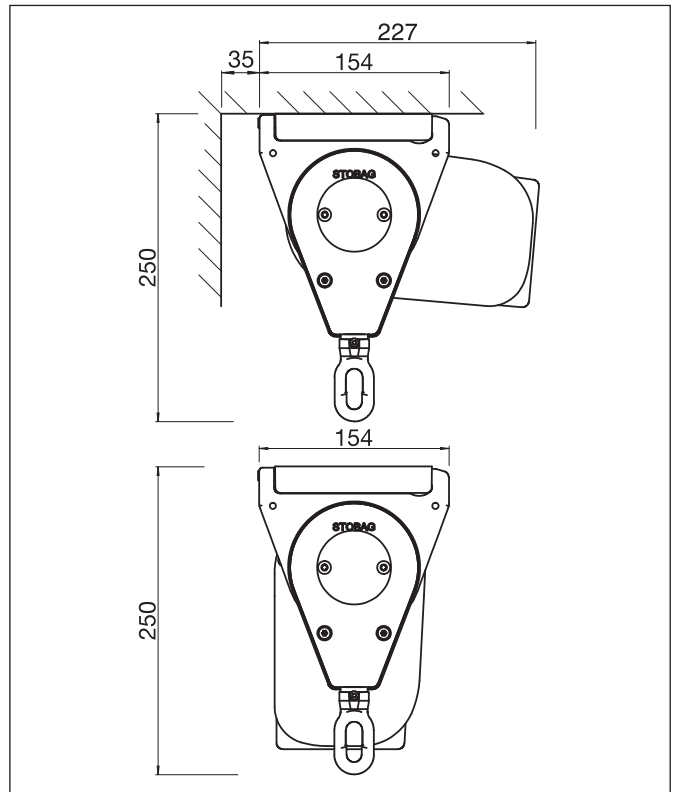
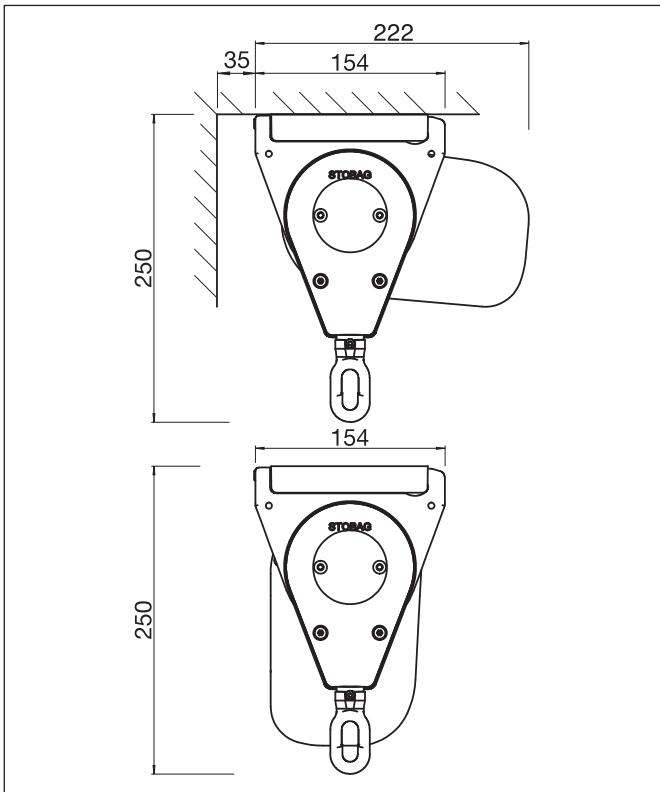



CASABOX BX2000

Cassette awning with folding arms

BX2000

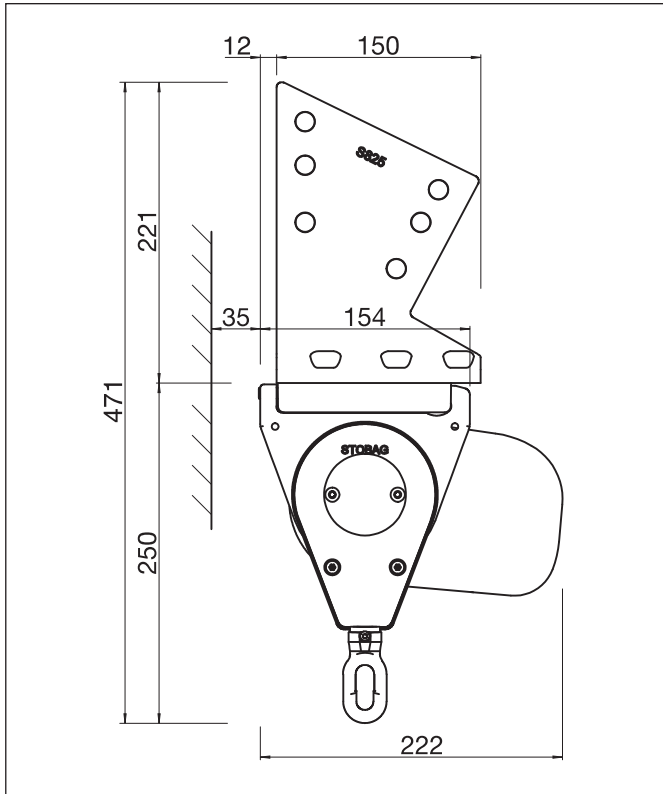

Rafter installation

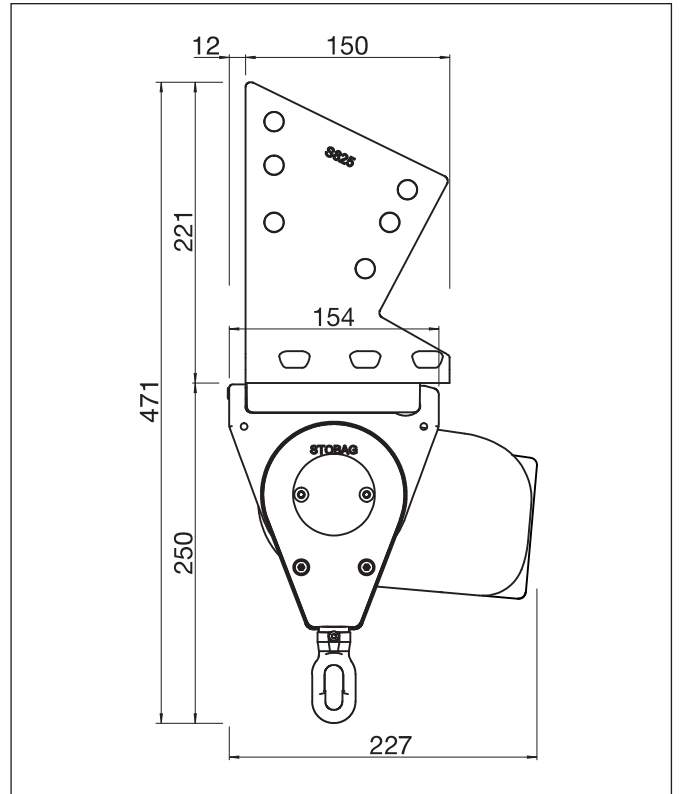

BX2000

Installation drawing

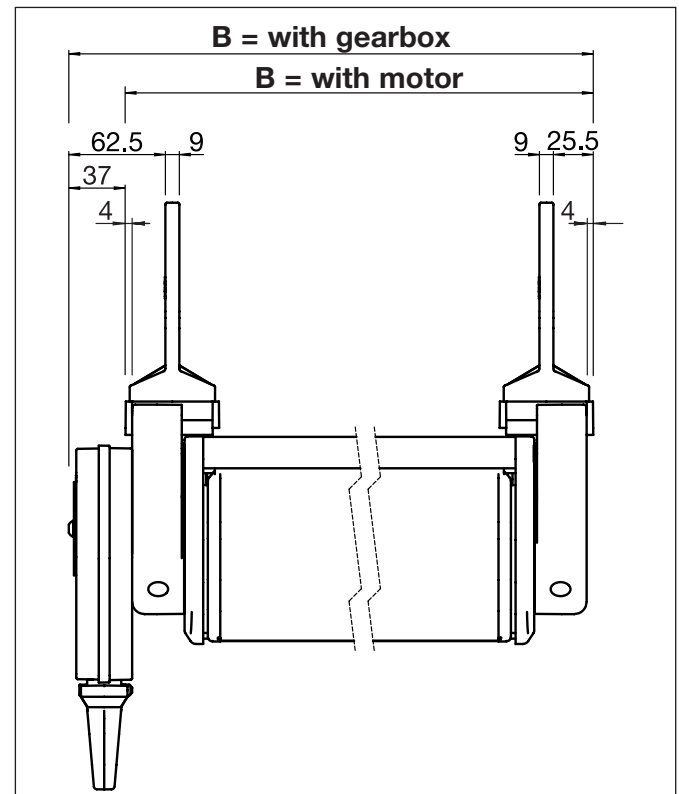
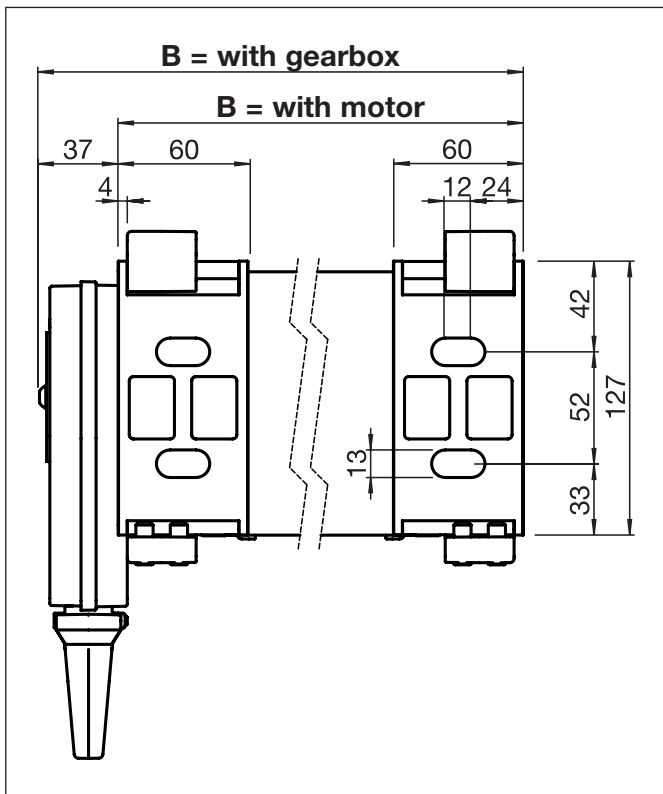

B = total width