

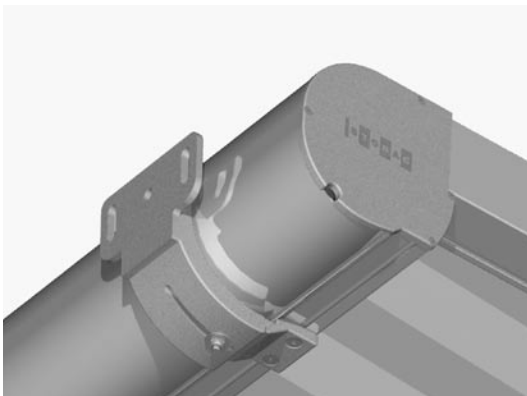

ALFRESCO P4000

Terrace Awning with integrated gutter

P4000



Description

Terrace awning with motor drive. Tensioning through awning cover. Extension and retraction of the awning with powerFlex 230V/50Hz AC motor with friction brake, electronic end stop switch and thermo-protection IP54 (spray water) protection with 4-pole connection as power supply.

Extruded aluminium box, one-piece, round, as load-bearing element with slot. Aluminium alloy cast end caps with no visible screws to close off box with gudgeons to connect to guide rails and to hold the roller tube bearings and motor bearings.

The awning is secured to the façade by adjustable wall mountings in cast aluminium alloy or ceiling angle bracket for ceiling fixing. Roller tube in galvanised steel with slot for awning cover. The end rail is an extruded aluminium chamber profile with slots for the cover and rollers at the side to guide the extension and retraction mechanism with integrated gas dampers and stainless steel pulley system to move the cover. The box is sealed by the retracted front rail and box front profile. Guide rails in extruded aluminium with chamber for the arch element. With integrated sliders for the guide rollers on the front rail and slot to fit the combi-holder, guiding roller tubes and strip light fixture. A StobLock manual front rail stop is fitted to the guides for optimum cover counter-tensioning.

The guide rails are screwed to a solid foundation using the galvanised steel foot-plates.

Extruded aluminium gutter for sideways drainage of the awning is simply clicked into the cast aluminium alloy combi-holder.

All visible screws are stainless steel.

Option:

An advertising banner can be fitted to the front to finish it. The extruded aluminium banner profile is fitted to the guide rail using the slot in the cast aluminium alloy banner bracket.

Additional lighting fixtures.

METHOD OF DELIVERY

Awning fully built-in to protection box with fitted cover. Guide rails, guide roller tubes, lighting fixtures, gutter, wall mountings, combi-holder and footplates separate.



* max. cover length 850cm

- 5% - 9%: Awning is suitable only as protection from the sun
- 10% - 53%: Awning is suitable for weather protection when fitted with waterproof PG2 cover



ALFRESCO P4000

Terrace Awning with integrated gutter

P4000

Wall fix

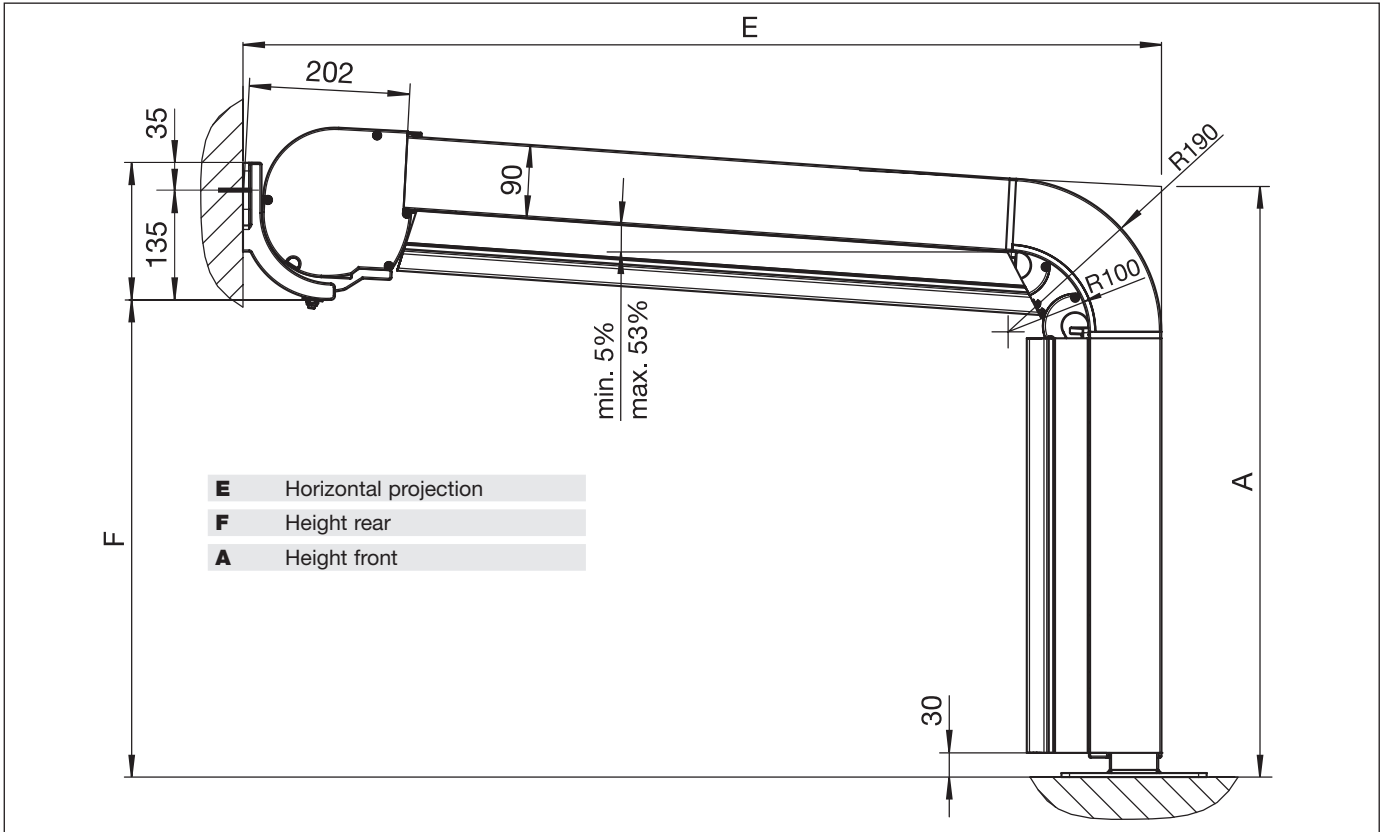

Wall fix with P318/1

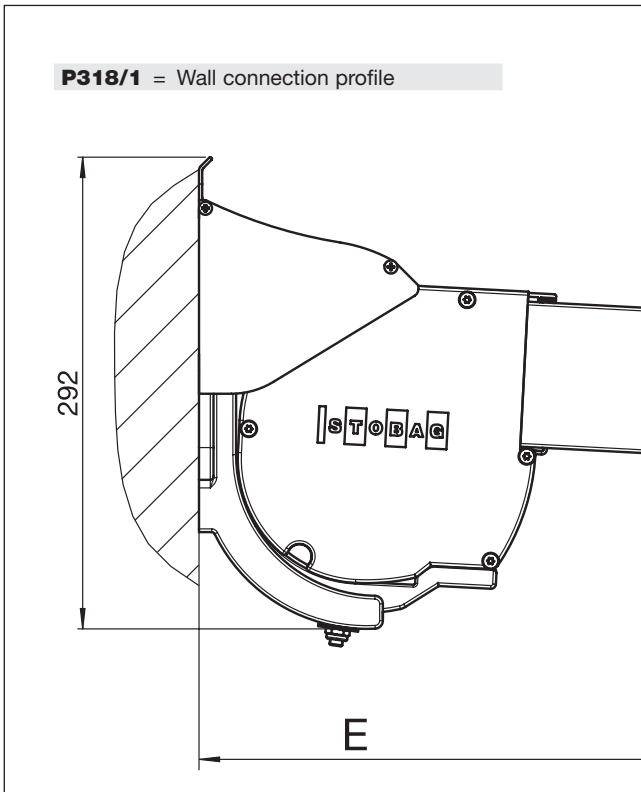

Top fix

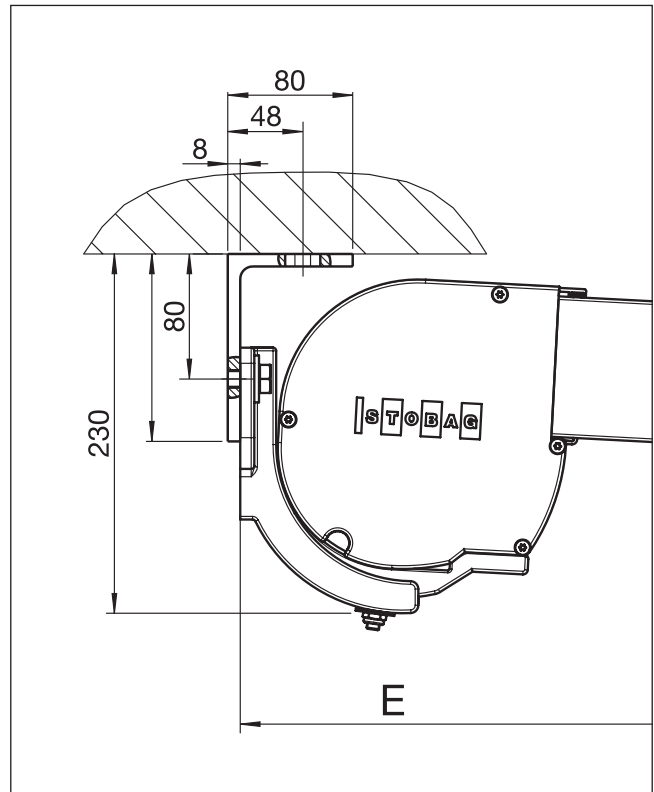



ALFRESCO P4000

Terrace Awning with integrated gutter

P4000

Installation plan

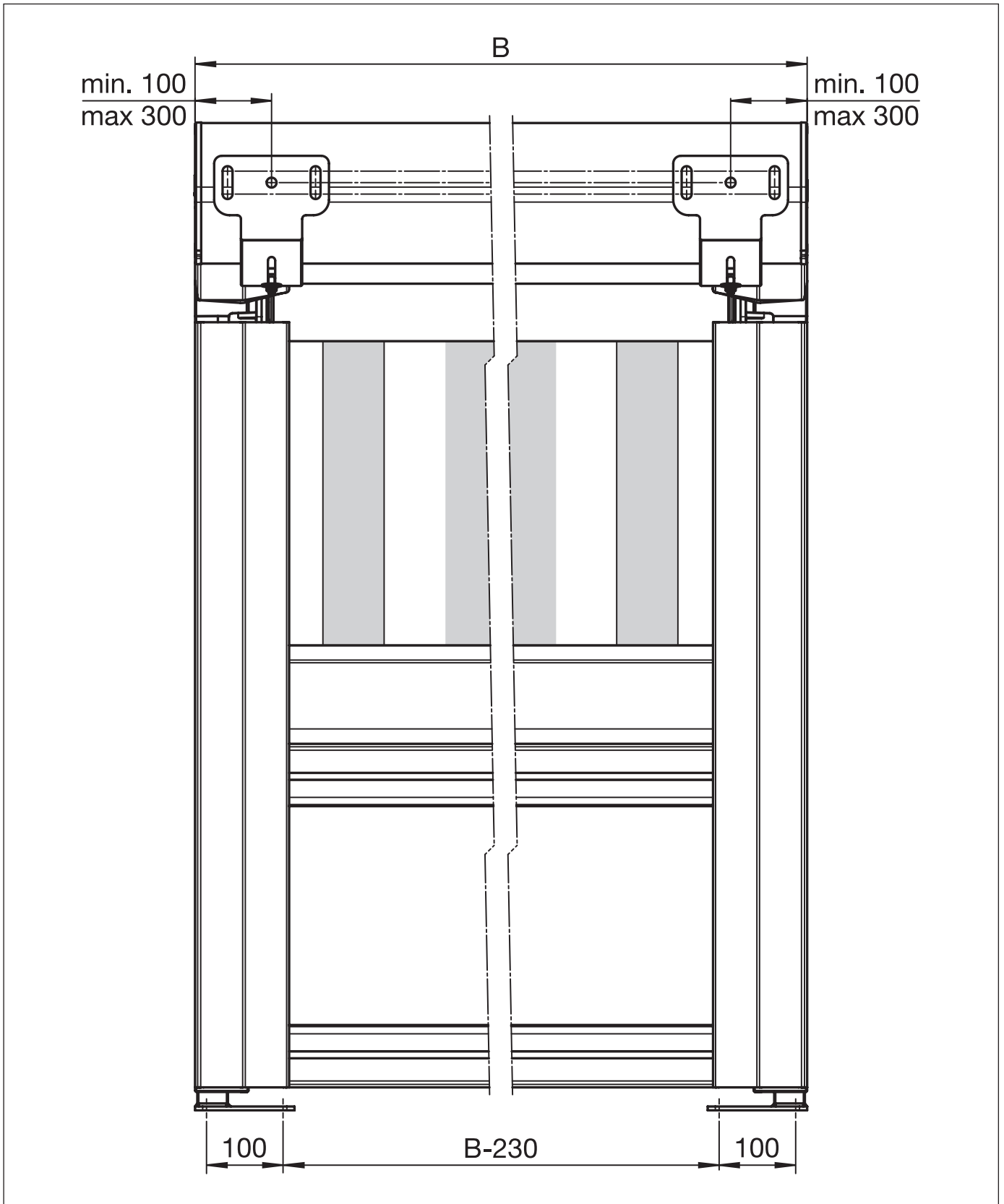

B = Total width